

DOOR SCHEDULE													
DOOR NO.	SIZE	MATERIAL	DOOR TYPE	FRAME TYPE	HARDWARE	REMARKS	DOOR NO.	SIZE	MATERIAL	DOOR TYPE	FRAME TYPE	HARDWARE	REMARKS
1	2-3070 X 1-3/4"	HM	B	-	-	VERIFY ACTUAL SIZE	31	2-3070 X 1-3/4"	HM	-	-	-	-
2	3070 X 1-3/4"	SCW	B	-	HW-1	-	32	3070 X 1-3/4"	SCW	B	-	HW-2	-
3	2668 X 1-3/4"	-	-	-	-	-	33	2640 X 1-3/8"	HCW	D	WD	HW-5	-
4	3068 X 1-3/8"	-	-	-	HW-1	VERIFY ACTUAL SIZE	34	3070 X 1-3/4"	SCW	A	-	HW-4	-
5	3068 X 1-3/8"	-	-	-	HW-1	VERIFY ACTUAL SIZE	35	2640 X 1-3/8"	HCW	D	-	HW-5	-
6	3070 X 1-3/4"	SCW	B	-	HW-2	-	36	3070 X 1-3/4"	SCW	B	-	HW-2	-
7	2668 X 1-3/8"	-	-	-	-	-	37	3070 X 1-3/4"	SCW	B	-	HW-2	-
8	3070 X 1-3/4"	SCW	B	-	HW-2	-	38	2640 X 1-3/8"	HCW	D	WD	HW-5	-
9	2668 X 1-3/8"	-	-	-	-	-	39	2640 X 1-3/8"	HCW	D	-	HW-5	-
10	2668 X 1-3/8"	-	-	-	-	-	40	3070 X 1-3/4"	SCW	B	-	HW-2	-
11	3070 X 1-3/4"	SCW	B	-	HW-2	-	41	3070 X 1-3/4"	SCW	B	WD	HW-2	CUT NEW DOOR
12	3070 X 1-3/4"	SCW	B	-	HW-2	-	42	2640 X 1-3/8"	SCW	B	-	HW-2	-
13	2668 X 1-3/8"	-	-	-	-	-	43	3070 X 1-3/4"	SCW	B	-	HW-2	-
14	3070 X 1-3/4"	SCW	B	-	HW-2	-	44	2640 X 1-3/8"	HCW	D	-	HW-5	-
15	2668 X 1-3/8"	-	-	-	-	-	45	3070 X 1-3/4"	SCW	B	-	HW-2	REVERSE FRAME
16	3070 X 1-3/4"	SCW	C	-	HW-4	-	46	2640 X 1-3/8"	HCW	D	WD	HW-5	-
17	3070 X 1-3/4"	HM	B	-	HW-3	-	47	3070 X 1-3/4"	SCW	B	-	HW-2	-
18	3070 X 1-3/4"	SCW	B	-	HW-1	-	48	3070 X 1-3/4"	-	-	-	HW-5	-
19	2-2870 X 1-3/4"	HM	-	-	-	-	49	3068 X 1-3/8"	SCW	A	-	HW-2	-
20	3070 X 1-3/4"	HM	B	-	HW-3	-	50	2640 X 1-3/8"	HCW	D	WD	HW-5	-
21	3068 X 1-3/8"	-	-	-	HW-1	-	51	2-3070 X 1-3/4"	-	-	-	-	-
22	3068 X 1-3/8"	-	-	-	HW-1	-	52	3070 X 1-3/4"	HM	A	-	HW-3	CUT NEW DOOR IN WALL
23	3070 X 1-3/4"	HM	B	-	HW-3	-	53	3070 X 1-3/4"	HM	A	-	HW-3	CUT NEW DOOR IN WALL
24	2-3070 X 1-3/4"	SCW	B	-	HW-2	-	54	3070 X 1-3/4"	HM	A	-	HW-3	CUT NEW DOOR IN WALL
25	3068 X 1-3/8"	-	-	-	-	-	55	3070 X 1-3/4"	HM	A	-	HW-3	CUT NEW DOOR IN WALL
26	3070 X 1-3/4"	SCW	A	-	HW-1	-	56	3070 X 1-3/4"	HM	A	-	HW-3	CUT NEW DOOR IN WALL
27	3070 X 1-3/4"	-	-	-	-	-	57	3070 X 1-3/4"	HM	A	-	HW-3	CUT NEW DOOR IN WALL
28	3068 X 1-3/8"	SCW	A	-	HW-2	VERIFY ACTUAL SIZE							
29	3070 X 1-3/4"	SCW	C	-	HW-1	HALF DOORS W/ WITH SHELF							
30	2668 X 1-3/8"	HCW	-	-	HW-1	-							

HM - HOLLOW METAL
 SCW - SOLID CORE WOOD
 HCW - HOLLOW CORE WOOD
 ALL HALL DOORS ARE 20 MIN. RATED

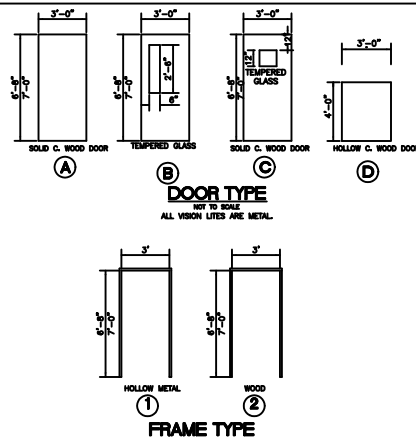

ROOM FINISH SCHEDULE					
ROOM	FLOOR	BASE	WALL	CEILING	REMARKS
CLASSROOM 1	-	-	PB	-	PATCH VCT
CLASSROOM 2	-	-	PB	-	PATCH VCT
CLASSROOM 3	-	-	PB	-	PATCH VCT
CLASSROOM 4	VCT	4" VINYL	PB	-	PATCH VCT
CLASSROOM 5	-	-	PB	-	PATCH VCT
EHS 1	VCT	4" VINYL	PB	LAT 1	CEILING AT 9'-0"
EHS 2	VCT	4" VINYL	PB	LAT 1	CEILING AT 9'-0"
EHS 3	VCT	4" VINYL	PB	LAT 1	CEILING AT 9'-0"
EHS 4	VCT	4" VINYL	PB	LAT 1	CEILING AT 9'-0"
EHS 5	VCT	4" VINYL	PB	LAT 1	CEILING AT 9'-0"
EHS 6	VCT	4" VINYL	PB	LAT 1	CEILING AT 9'-0"
BOYS 1	-	6" VINYL	PB	LAT 2	
GIRLS 1	-	6" VINYL	PB	LAF 2	
STAFF	-	-	PB	-	
HALL 1	VCT	-	PB	LAT 1	CEILING AT 9'-6"
HALL 2	VCT	-	PB	LAT 1	CEILING AT 9'-6"
HALL 3	VCT	-	PB	LAT 1	PAINT FLOOR
STEPS	-	-	PB	-	PAINT FLOOR
JANITOR	-	-	-	-	PAINT FLOOR
STORAGE 1	-	-	-	-	-
STORAGE 2	-	-	-	-	-
STORAGE 3	-	-	-	-	-
KITCHEN	-	-	-	PAINT	PAINT CABINETS
PANTRY	VCT	4" VINYL	PB	-	
STAGE	-	-	PB	-	
OFFICE 1	-	-	PB	LAT 1	
OFFICE 2	-	-	PB	-	
OFFICE 3	-	-	PB	-	
OFFICE 4	-	-	PB	-	
OFFICE 5	VCT	4" VINYL	PB	PAINT	REMOVE CARPET
OFFICE 6	VCT	4" VINYL	PB	PAINT	REMOVE CARPET

VCT - VINYL COMPOSITION TILE
 LAT - LAY IN ACOUSTICAL TILE SV - SHEET VINYL
 PB - PAINTED BLOCK, PANELING, PLASTER OR GYP

GENERAL NOTES

- All work shall comply with applicable local, state and national codes, laws, rules and regulations and they are hereby made a part of these specifications as though they were herein written in full.
- All Contractor's work shall be guaranteed for one year from the final date of acceptance by the Owner.
- All permits, licenses and fees shall be paid by the Contractor.
- Remove all trash and debris from the job daily.
- Contractor is responsible for the removal, replacement and/or repair of all necessary items to perform his work.
- Time is of essence and Contractor shall schedule work as required to complete job in the time allocated for work to be complete.
- Exterior Work Description
 - All gray colored areas on the exterior shall be painted. Prior to painting contractor shall pressure wash to remove all loose paint and or rust. Metal shall be prime painted.
 - Build new porches and ramps on the south side as detailed.
 - Install new covered entrance as detailed in Alternate No. 2.
 - Install new 2" wearing surface asphalt to parking lot and front entrance in Alternate No. 3.
 - Install five new 6" dia. concrete bollards to protect new columns. Mount in 16" dia. footings 24" deep.
 - Install 3 new light fixtures in new soffit.
- Paint all interior doors, walls, frames, windows, etc., in rooms with a minimum of two coats of enamel paint where indicated. Patch any damaged walls, etc., prior to painting.
- All paint used on the job shall be enamel by Glidden, Sherwin Williams, or Benjamin Moore or an approved equal. Renovator must be certified by MDEQ to perform Lead Based Paint Activities.
- Metal wall panels shall be equal to McGraw Metal, Inc's Max RB (26 gauge) with Kynar 500 Finish from it's standard color chart. 20 year finish warranty covering rupture, checking, blistering, peeling, fading, chipping, and chalking.
- Install new floor tile and base in Hall from front door to rear. (Approx. 186 lf). Tile to have 12" border. at walls. Provide reducer strips at doors.
- Remove existing cabinets, walls, etc. as noted. After removal of cabinets Contractor shall patch floor tile.
- EXISTING FLOOR TILE SHALL NOT BE SANDED AT ANY TIME. THE FLOOR SHALL BE STRIPPED WITH A NONE ABRASIVE CLEANER AND SHALL BE CONSIDERED AS ASBESTOS AND THEREFORE CARE SHALL BE TAKEN TO INSURE THAT IT IS NOT DAMAGED. PATCH ANY AND ALL CRACKS BEFORE INSTALLATION OF NEW TILE OR CARPET.
- Install fire code gypsum on both sides of windows in Halls. Symbol Δ (6x2) Symbol Δ (3x2) Provide wood blocking as required.
- Install new metal mini blinds at all windows.
- Install new concrete topping on porch areas at Doors 31 and 51. Hold back 12" from front edge to create a new step.
- Alternate No. 1 - Contractor shall drop the ceilings in the rooms indicated.
- Where new door frames are required. Build to match existing along Halls on the interior.
- Where new doors are cut into the exterior Contractor shall trim out edges of new cut brick with 26 gauge metal prefinish trim metal. Patch floors for smooth tie into wood porches and ramp.

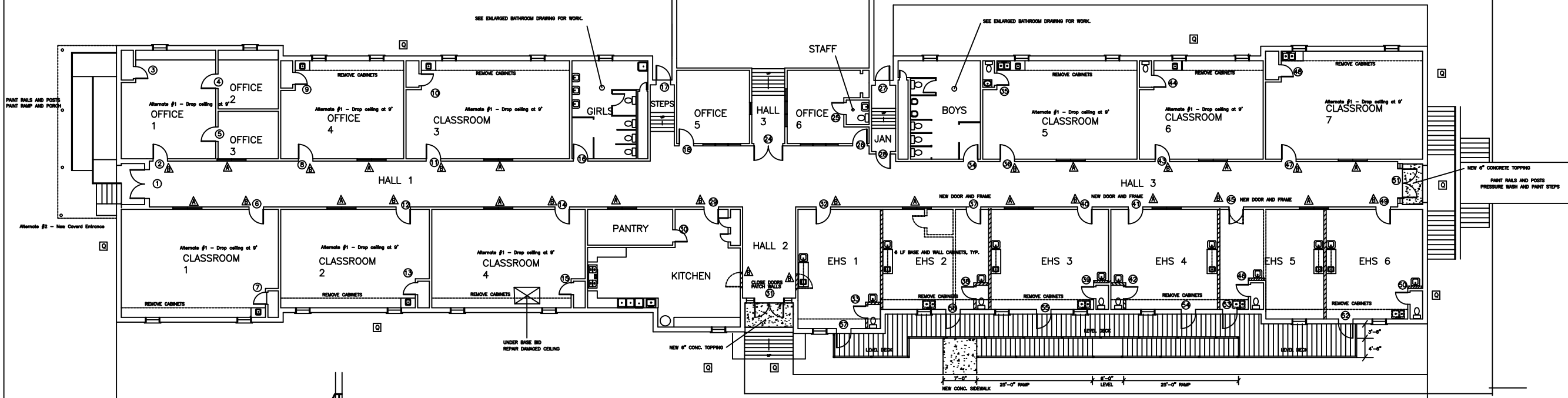
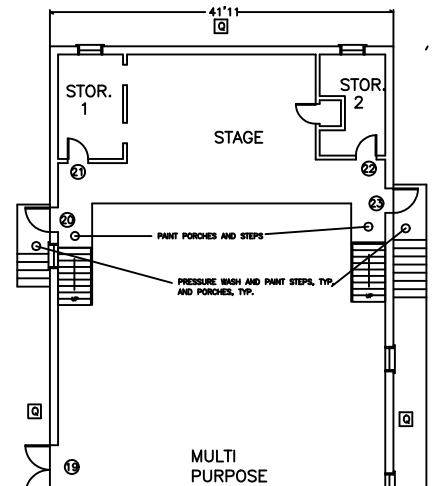

WESTBROOK HEAD START CENTER
 SCALE: 3/32" = 1' - 0"
 17,923 GSF

- LEGEND**
- ▨ New partition walls of 2x4 SYP wood studs at 16" o.c. with 5/8" fire gypsum on both sides.
 - Existing partitions to be removed. Patch floors, walls, etc., where demo stops.
 - Scrape down and pressure wash to remove all loose and peeling paint on existing walls, etc. Apply two coats of industrial enamel paint.

NEW DOOR FRAMES ON HALL 3
 Reuse door framing material from Hall 2 doors removed for new door frames at Door 37 and Door 41.

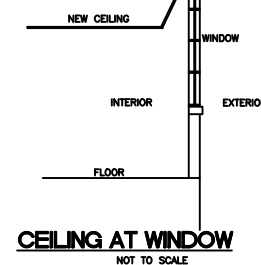

WESTBROOK HEAD START CENTER
 411 ST. AUGUSTINE AVE.
 MCCOMB, MS 39648
 601-684-9854

WESTBROOK HEAD START CENTER		FLOOR PLAN		1	
SCALE: AS SHOWN	DRAWN BY: RDW	DATE: 9/10/21	CHECK: ADL	OF 3	

ENGINEERING TECHNOLOGIES
LAD
 JACKSON, MS 39286
 P. O. BOX 31379
 601-362-0866
MISSISSIPPI ACTION FOR PROGRESS, INC.
 JACKSON, MISSISSIPPI 39209
 1751 MORSON ROAD